

SPECIFICATIONS

ELECTRICAL

FREQUENCY RANGE_____DC - 65 GHz
STANDARD dB VALUES_____SEE CHART A

ATTENUATION ACCURACY_____DC - 26.5 GHz 26.5 - 40 GHz 40 - 60 GHz 60 - 65 GHz
1-9 dB _____±0.75 dB ±1.0 dB ±1.5 dB ±1.5 dB
10 dB _____±0.75 dB ±1.25 dB ±1.5 dB ±1.75 dB
20 dB _____±1.0 dB ±1.25 dB ±2.0 dB ±2.5 dB
30 dB _____±1.25 dB ±1.5 dB ±2.0 dB ±5.0 dB

VSWR _____DC-26.5 GHz 26.5 - 40 GHz 40 - 65 GHz
<1.35 <1.55 <1.65

INPUT POWER (AVG. MAX.)_____1 WATT @25°C SEE TABLE
DERATES LINEARLY TO 10% AT +100°C from + 25°

IMPEDANCE_____50 OHMS (NOM.)

OPERATING/STORAGE TEMP. RANGE____-55 TO +100°C

MATERIAL

HOUSING: STAINLESS STEEL IAW ASTM-A484 & ASTM-A582, ALLOY 303, COND A

CONTACT: BERYLLIUM COPPER

DIELECTRIC - TEFLON

FINISH

HOUSING - PASSIVATED STAINLESS STEEL

CONDUCTOR - GOLD PLATED IAW MIL-PRF-39012

RoHS COMPLIANT DEVICE

MARKING

PART LOOKS LIKE PRODUCT IMAGE ABOVE.

PART MARKING ORIENTATION AND FORMAT AS SHOWN (CURVED SURFACE).

dB = SEE WORK ORDER FOR TWO DIGIT dB VALUE.

MARKING TO BE AS LARGE AS POSSIBLE. .020" SHOWN.

TEXT HEIGHT IS SUGGESTED ONLY, FIT AS DICTED.

YYWW EQUALS DATE CODE.

Precision
Wireless

POWERED BY
Omni Spectra®

外来文件受控章

REVISIONS

REV	DESCRIPTION	ECO #	DATE	APPROVED
-	INITIAL RELEASE	16-128	6/6/16	T.KUHN
A	ADDED TO CHART A	18-182	12/12/18	T.KUHN

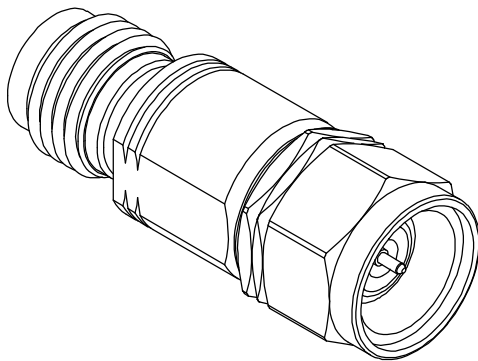
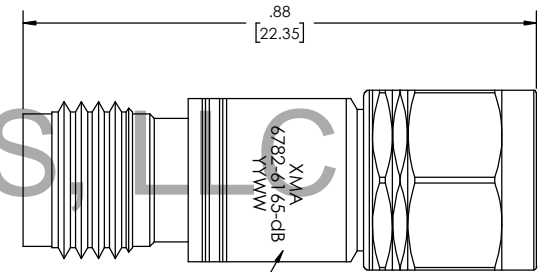
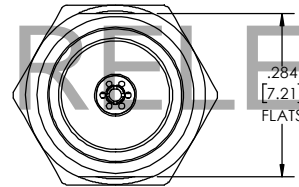
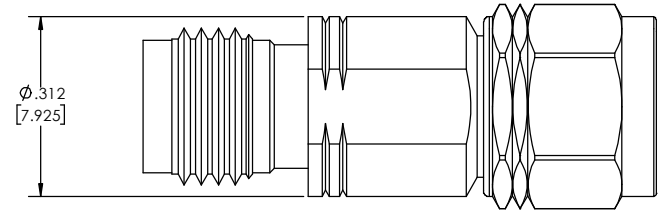

CHART A	
-dB	MARKED dB VALUE
01	01
02	02
03	03
04	04
05	05
06	06
07	07
08	08
09	09
10	10
20	20
30	30

DRAWING PRACTICES PER ANSI Y14.5 UNLESS OTHERWISE SPECIFIED TOLERANCES IN: DECIMALS INCH (MM) X" .05" [1.27] .XX" .03" [.76] .XXX" .010" [.25] FINISH: 63 MATERIAL: NOTE: THIS DRAWING INCORPORATES THIRD ANGLE PROJECTION. INTERPRET IAW ANSI Y14.5-1982		UNLESS OTHERWISE SPECIFIED TOLERANCES IN: DECIMALS INCH (MM) X" .05" [1.27] .XX" .03" [.76] .XXX" .010" [.25] ANGLES ±0°30' REMOVE ALL BURRS/SHARP W/ BREAK / R OF .003" TO .0005" UNLESS OTHERWISE NOTED DIAS CONCENTRIC <.003 T.I.R. DO NOT SCALE PRINT		DRAWN DATE MCCORMICK07/16/14 CHECKED DATE MCCORMICK07/16/14 ENG APPR. DATE T.KUHN 0/16/14 THESE DRAWINGS AND SPECIFICATIONS ARE THE PROPERTY OF XMA CORP. OR OMNI SPECTRA AND SHALL NOT BE REPRODUCED COPIED NOR USED IN WHOLE OR IN PART AS A BASIS FOR THE MANUFACTURE OR SALE OF OTHER ITEMS WITHOUT THE EXPRESS WRITTEN PERMISSION OF XMA CORP.	
---	--	--	--	---	--

QTY.	PART NUMBER	DESCRIPTION	ITEM NO.
X	6782-6165-dB	ATTENUATOR, 1.85mm, MALE TO FEMALE, DC-65 GHz, 1 WATT	
1	TA-6782-6165-dBU	ASSEMBLY, ATTENUATOR, 1.85mm, MALE TO FEMALE, DC-65 GHz, 1 WATT, UNMARKED	1
ATTENUATOR, 1.85mm, MALE TO FEMALE, DC-65 GHz, 1 WATT			
SIZE C	CAGE CODE 3HT76	DRAWING NUMBER 6782-6165-dB	REV A
SCALE	PLATED AREA SQ. IN	SHEET 1 of 1	



Phone:603-222-2256 Fax:603-222-2259
7 Perimeter Road, Manchester, NH 03103