

4

3

2

1



REVISIONS				
REV	DESCRIPTION	ECO #	DATE	APPROVED
E	ADDED MARKING/UPDATED FORMAT	15-203	6/25/15	T.KUHN
F	REVISED MARKING	15-257	9/1/15	T.KUHN
G	DELETED 2002-6118-0X FROM TABLE	17-113	7/20/17	T.KUHN
H	4-12.4GHZ VSWR WAS 1.05:1, 6117 AND 6117	18-121	8/13/18	T.KUHN

SPECIFICATIONS

ELECTRICAL

FREQUENCY RANGE _____ DC - 25.6 GHz
 VSWR _____ SEE TABLE
 IMPEDANCE _____ 50 OHMS
 TEMPERATURE RANGE _____ -65°C TO +125°C
 POWER (AVG) _____ 1 WATTS
 POWER DERATES LINEARLY FROM +45°C TO <10% @+125°C
 POWER (PEAK) _____ 500 WATTS
 (<5 μ SEC PW, <1% DUTY CYCLE)

MECHANICAL

INNER CONDUCTOR: _____ BERYLLIUM COPPER PER
 ASTM B196 & B197.
 OUTER CONDUCTOR: _____ STAINLESS STEEL, PER ASTM
 A484 & A582, CLASS 303, COND. A.
 DIELECTRIC: _____ TEFLON PER ASTM D1710.

FINISH

INNER CONDUCTOR: _____ GOLD PLATED PER MIL-PRF-39012.
 HOUSING/COUPLING NUT FINISH PER SUFFIX (REPLACING -0X IN P/N)
 -00 OUTER CONDUCTOR/NUT GOLD PLATED
 -02 OUTER CONDUCTOR/NUT PASSIVATED SS
 CONNECTOR INTERFACE COMPLIES WITH MIL-PRF-39012 AND MIL-STD-348
 FOR SMA MATING CHARACTERISTICS.

MARKING

PART LOOKS LIKE PRODUCT IMAGE ABOVE.
 PART MARKING ORIENTATION AND FORMAT AS SHOWN.
 MARKING TO BE AS LARGE AS POSSIBLE, CLEAR AND READABLE.
 YYWW EQUALS DATE CODE.
 ADD "C" TO THE END OF PART NUMBER FOR CHAINED UNITS. (EXCLUDING
 PARTS 2002-6105-0X AND 2002-6115-0X)

FREQUENCY (GHz)	VSWR DC-4 (GHz)	VSWR 4-12.4 (GHz)	VSWR 12.4-18 (GHz)	VSWR 18-26.5 (GHz)	PART NUMBER
DC-4	DC-1 1.05:1 2-4 1.10:1	-	-	-	2002-6151-0X
DC-12.4	1.05:1	1.10:1	-	-	2002-6116-0X
DC-18	1.05:1	1.10:1	1.25:1	-	2002-6144-0X
	1.05:1	1.15:1	1.15:1	-	2002-6105-0X *
	1.05:1	1.15:1	1.15:1	-	2002-6100-0X
	1.05:1	1.15:1	1.20:1	-	2002-6101-0X
	1.09:1	1.17:1	1.23:1	-	2002-6143-0X
	1.05:1	1.10:1	1.10:1	-	2002-6117-0X
	1.10:1	1.10:1	1.10:1	-	2002-6111-0X
	1.05:1	1.15:1	1.20:1	-	2002-6112-0X
DC-26.5	1.10:1	1.20:1	1.30:1	-	2002-6113-0X
	1.10:1	1.20:1	1.30:1	-	2002-6115-0X *
	1.05:1	1.10:1	1.20:1	1.30:1	2002-6110-0X
	1.05:1 + .007f (GHz)		1.05 @ DC TO 1.24 @ 26.5 GHz		2002-6119-0X

* WITH 2" TO 2.5" MONEL BEAD CHAIN

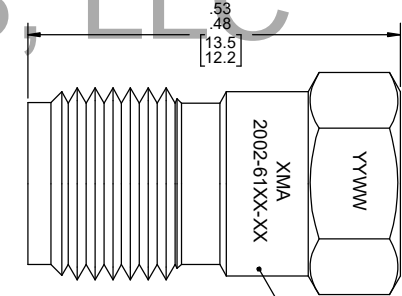
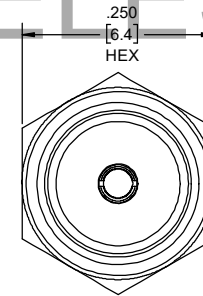

MARKING AREA

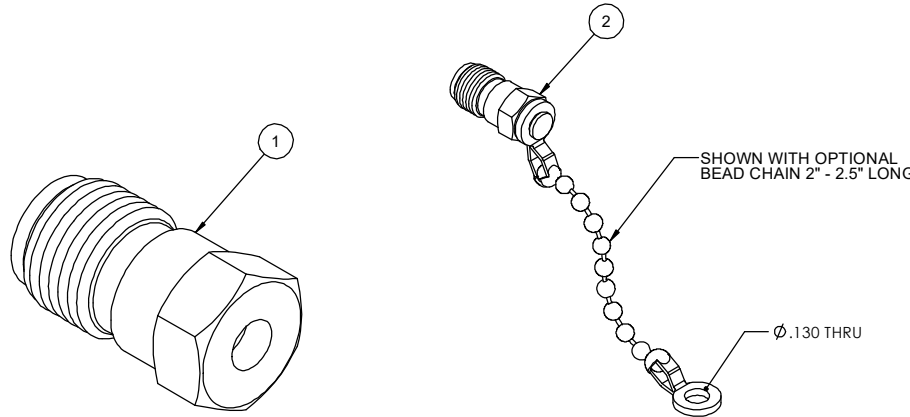

NO CHAIN	CHAIN	PART NUMBER	DESCRIPTION	ITEM NO.
		2002-61XX-0X	TERMINATION, SMA-f, DC-26.5 GHz	
1	-	TA-2002-6000-0XYYU	ASSEMBLY, TERMINATION, SMA-f, DC-26.5 GHz, UNMARKED	1
-	1	TA-2002-6000-0XYYUC	ASSEMBLY, TERMINATION, SMA-f, DC-26.5 GHz, CHAINED, UNMARKED	2

DRAWING PRACTICES PER ANSI Y14.5 B1-2010-10 & 1000		UNLESS OTHERWISE SPECIFIED TOLERANCES IN:		DRAWN DATE MCCORMICK 6/25/15	
DIMENSIONS ARE IN INCHES AND APPLY BEFORE/AFTER PROCESSING		DECIMALS	INCH	MM	CHECKED DATE MCCORMICK 6/25/15
SURFACE FINISH		.X"	.05"	[1.27]	ENG APPR. DATE T.KUHN 6/25/15
FINISH: SEE NOTE		.XX"	.03"	[.76]	
MATERIAL: SEE NOTE		.XXX"	.010"	[.25]	
NOTE: THIS DRAWING INCORPORATES THIRD ANGLE PROJECTION.		ANGLES ±0°30'		THESE DRAWINGS AND SPECIFICATIONS ARE THE PROPERTY OF XMA CORP. OR OMNI SPECTRA AND SHALL NOT BE REPRODUCED, COPIED NOR USED IN WHOLE OR IN PART AS A BASIS FOR THE MANUFACTURE OR SALE OF OTHER ITEMS WITHOUT THE EXPRESS WRITTEN PERMISSION OF XMA CORP.	
INTERPRET LAW ANSI Y14.5-1982		DO NOT SCALE PRINT		CAGE CODE 3HT76	

DRAWING NUMBER 2002-61XX-0X		REV H	
SCALE		SHEET 1 OF 1	

TERMINATION, SMA-f, DC-26.5 GHz, 1W			
SIZE C	CAGE CODE 3HT76	DRAWING NUMBER 2002-61XX-0X	REV H

4

3

2

1