

# ADAPTERS, BETWEEN SERIES

SMA / 2.9mm, DC - 26.5 GHz

## SPECIFICATIONS:

Model: 5262, 5263, 5264, 5265

**RoHS**  
Compliant

**AEROFLEX**  
A passion for performance.

### Electrical:

Frequency Range \_\_\_\_\_ DC - 26.5 GHz  
 VSWR \_\_\_\_\_ 1.25:1 Max.  
 Impedance \_\_\_\_\_ 50 Ohms  
 Operating Temp Range \_\_\_\_\_ -65°C to +125°C

### Mechanical:

SMA Connectors \_\_\_\_\_ Passivated Stainless Steel  
Mates with MILSTD-348  
 2.9mm Connectors \_\_\_\_\_ Passivated Stainless Steel  
Mates with SMA, 3.5mm and K\* Connectors  
 as well as SMK IAW MILSTD-348  
 Conductors \_\_\_\_\_ Gold Plated Beryllium Copper

\*K is a trademark of Anritsu Corp.

Model Number: **5262**  
SMA Male to 2.9mm Male

Model Number: **5263**  
SMA Female to 2.9mm Male

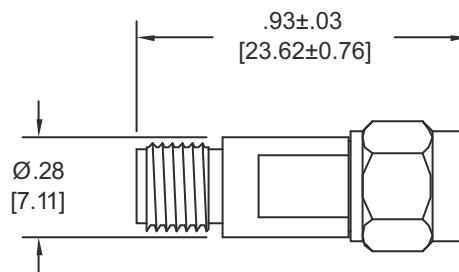
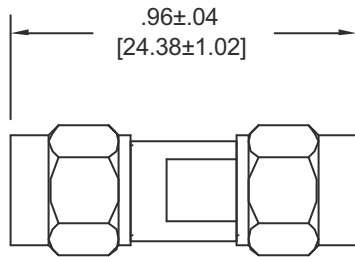

Model Number: **5264**  
SMA Male to 2.9mm Female

Model Number: **5265**  
SMA Female to 2.9mm Female

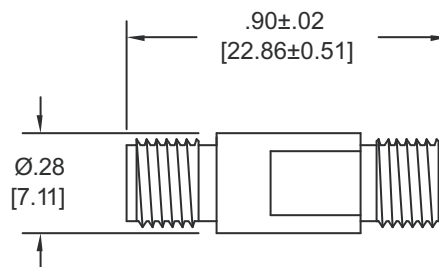
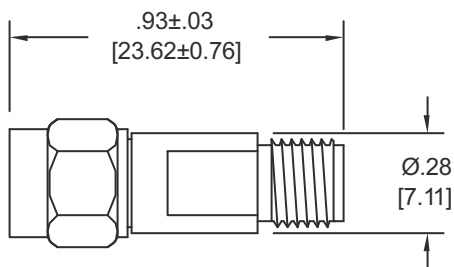

Note: Dimensions in Brackets are Expressed in Millimeters and are for Reference Only.  
 Units that offer very low return loss (VSWR) are also available.

5262: REV -

**AEROFLEX**  
INMET

Aeroflex / Inmet, Inc. • 300 Dino Drive, Ann Arbor, MI 48103 • U.S.A.  
 888-244-6638 or 734-426-5553 • FAX: 734-426-5557  
 www.aeroflex-inmet.com • inmet-sales@eroflex.com