

# TERMINATIONS

SMA, DC - 18 GHz, 5 Watts

## SPECIFICATIONS:

Models: TSXXXM-5W, TSXXXF-5W

**RoHS**  
Compliant

**AEROFLEX**  
A passion for performance.

### Electrical:

Frequency Range \_\_\_\_\_ DC - 18 GHz  
Standard Freq. Values \_\_\_\_\_ 6, 12.4 & 18 GHz  
VSWR \_\_\_\_\_  
DC - 4 GHz \_\_\_\_\_ 1.10:1 Max.  
4 - 8 GHz \_\_\_\_\_ 1.15:1 Max.  
8 - 12.4 GHz \_\_\_\_\_ 1.20:1 Max.  
12.4 - 18 GHz \_\_\_\_\_ 1.25:1 Max.  
Impedance \_\_\_\_\_ 50 Ohms  
Input Power \_\_\_\_\_ 5 Watts Avg. @ +25°C  
Derated Linearly to 1 Watt @ +125°C  
Operating Temp Range \_\_\_\_\_ -65°C to +125°C

### Mechanical:

SMA Connectors \_\_\_\_\_ Passivated Stainless Steel  
Mates with MIL-STD-34B \_\_\_\_\_  
Housing \_\_\_\_\_ Anodized Aluminum  
Conductors \_\_\_\_\_ Gold Plated Beryllium Copper

Model Number: **TSXXXM-5W**  
SMA Male Connector

Model Number: **TSXXXF-5W**  
SMA Female Connector

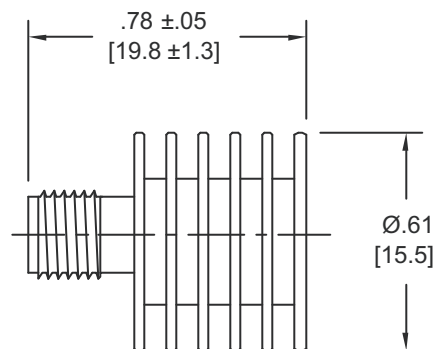
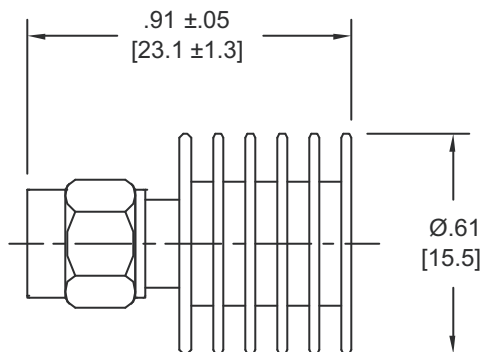

## HOW TO ORDER:

Model Number: **TSXXX~~Y~~-5W**

Frequency Range \_\_\_\_\_ Connector Configuration \_\_\_\_\_  
060 = DC - 6 GHz M = Male  
120 = DC - 12.4 GHz F = Female  
180 = DC - 18 GHz

### Ordering Examples:

Model Number: **TS120M-5W**  
DC - 12.4 GHz; SMA Male

Model Number: **TS060F-5W**  
DC - 6 GHz; SMA Female

Model Number: **TS180M-5W**  
DC - 18 GHz; SMA Male

Note: Dimensions in Brackets are Expressed in Millimeters and are for Reference Only.  
Units that operate over a more specific band as well as units which offer very low return loss (VSWR) over a specific or entire frequency range are also available.

TS180-5W: REV G

**AEROFLEX**  
INMET

Aeroflex / Inmet, Inc. • 300 Dino Drive, Ann Arbor, MI 48103 • U.S.A.  
888-244-6638 or 734-426-5553 • FAX: 734-426-5557  
www.aeroflex-inmet.com • inmet-sales@eroflex.com