

GPO(SMP) STRAIGHT JACK
WITH 2 HOLE FLANGE

GPO-KFB2

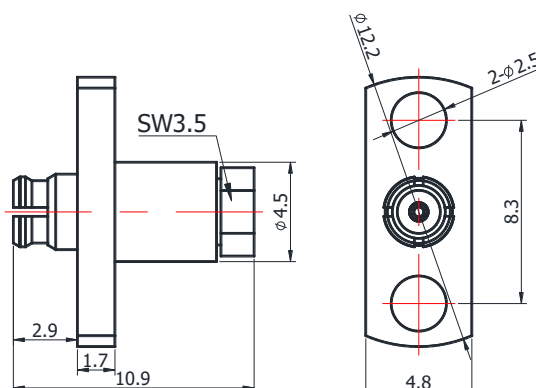

*Dimensions are in mm

Configuration

| | |
|----------------------------|-----------------|
| Connector 1 Type | GPO(SMP) Female |
| Connector 1 Impedance | 50 Ohms |
| Connector 1 Polarity | Standard |
| Body Style | Straight |
| Connector Mount Method | 2 Hole Flange |
| Connector 2 Interface Type | 086 Series |
| Cable Attachment Method | Solder |

Electrical Specifications

| | |
|---------------------|--|
| Frequency | DC to 40 GHz |
| Insertion Loss (dB) | $\leq 0.1 \times \text{Sqrt.}(f_GHz)$ |
| VSWR /Return Loss | ≤ 1.5 |

Materials Information

| | |
|----------------|------------------|
| Center Contact | CuBe Gold Plated |
| Outer Contact | CuBe Gold Plated |
| Body | CuBe Gold Plated |
| Dielectric | PTFE |

Environmental Data

| | |
|-------------------|-----------------|
| Temperature Range | -40°C to +155°C |
| 2002/95/EC(RoHS) | Compliant |

While the information has been carefully compiled to the best of our knowledge, nothing is intended as representation or warranty on our part and no statement herein shall be construed as recommendation to infringe existing patents. In the effort to improve our products, we reserve the right to make changes judged to be necessary.