

# ADAPTERS, BETWEEN SERIES

Type N / SMA, DC - 18 GHz, Bulkhead Mount

## SPECIFICATIONS:

Models: 5209, 5210, 5212, 5213

**RoHS**  
Compliant

### Electrical:

Frequency Range \_\_\_\_\_ DC - 18.0 GHz  
VSWR \_\_\_\_\_ 1.20:1 Max.  
Impedance \_\_\_\_\_ 50 Ohms  
Temperature Range \_\_\_\_\_ -65°C to +125°C

### Mechanical:

Connectors \_\_\_\_\_ Passivated Stainless Steel  
Mates with MILSTD-348  
Conductors \_\_\_\_\_ Gold Plated Beryllium Copper  
Nut & Washer \_\_\_\_\_ Passivated Stainless Steel  
O-Ring \_\_\_\_\_ Silicone Rubber

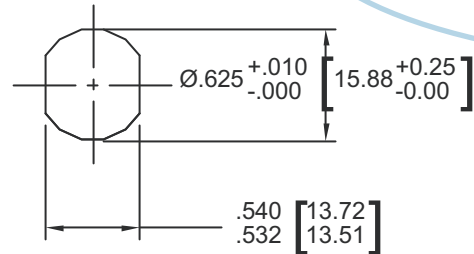

Recommended Panel Configuration

Model Number: **5213**  
Type N Female / SMA Male  
\*Includes O-Ring as Shown

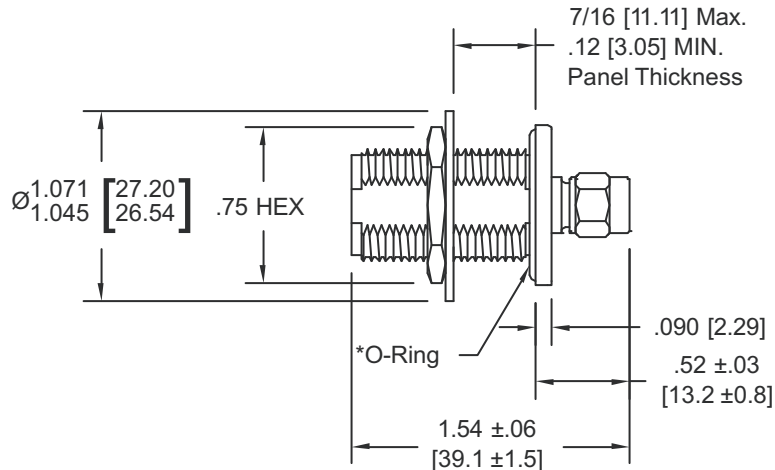

Model Number: **5210**  
Type N Female / SMA Male  
No O-Ring Included

Model Number: **5212**  
Type N Female / SMA Female  
\*Includes O-Ring as Shown

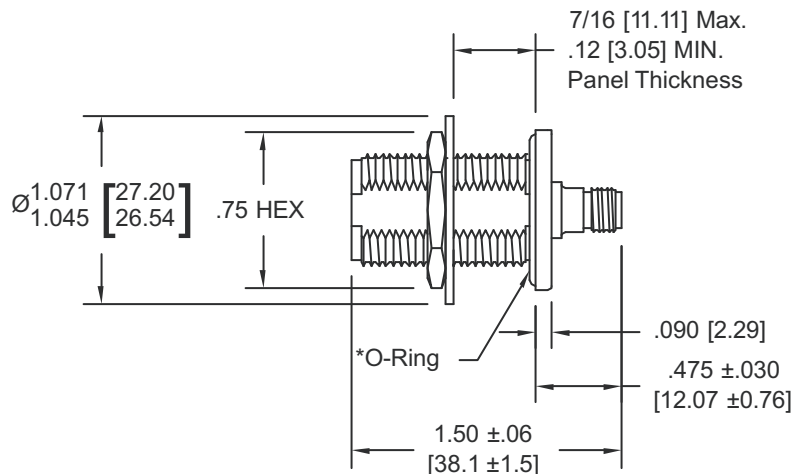

Model Number: **5209**  
Type N Female / SMA Female  
No O-Ring Included

Note: Dimensions in Brackets are Expressed in Millimeters and are for Reference Only.

5213: REV D



Aeroflex / Inmet, Inc. • 300 Dino Drive, Ann Arbor, MI 48103 • U.S.A.  
888-244-6638 or 734-426-5553 • FAX: 734-426-5557  
www.aeroflex-inmet.com • inmet-sales@eroflex.com