

ADAPTERS, IN-SERIES

1.85mm, DC - 65 GHz

SPECIFICATIONS:

Models: 5173, 5174, 5175

RoHS
Compliant

Electrical:

Frequency Range _____ DC - 65 GHz
 VSWR
 DC - 26.5 GHz _____ 1.25:1 Max.
 26.5 - 50 GHz _____ 1.35:1 Max.
 50 - 65 GHz _____ 1.40:1 Max.
 Impedance _____ 50 Ohms
 Operating Temp Range _____ -65°C to +125°C

Mechanical:

Connectors _____ Passivated Stainless Steel
Mates with 2.4mm & V* Connectors
 Conductors _____ Gold Plated Beryllium Copper

* V is a Trademark of Anritsu Corp.

AEROFLEX
A passion for performance.

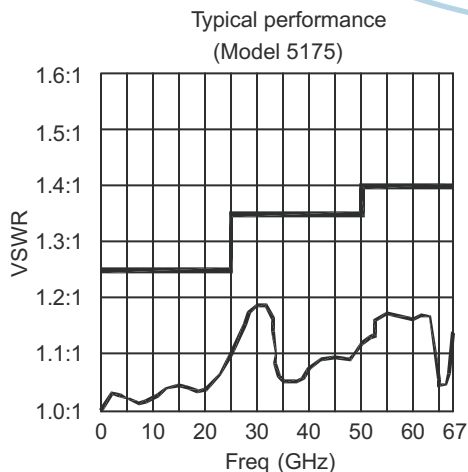

Model Number: **5175**
Male/Female Connectors

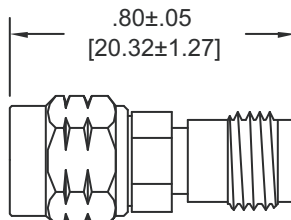

Model Number: **5174**
Male/Male Connectors

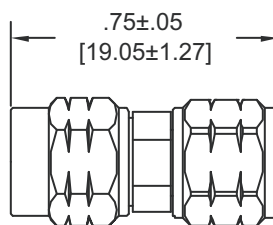

Model Number: **5173**
Female/Female Connectors

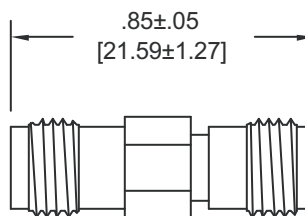

Note: Dimensions in Brackets are Expressed in Millimeters and are for Reference Only.

5175: REVA

AEROFLEX
INMET

Aeroflex / Inmet, Inc. • 300 Dino Drive, Ann Arbor, MI 48103 • U.S.A.
 888-244-6638 or 734-426-5553 • FAX: 734-426-5557
 www.aeroflex-inmet.com • inmet-sales@aeroflex.com