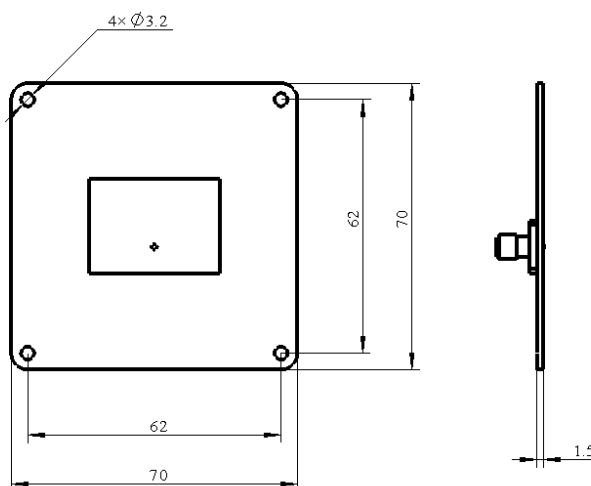
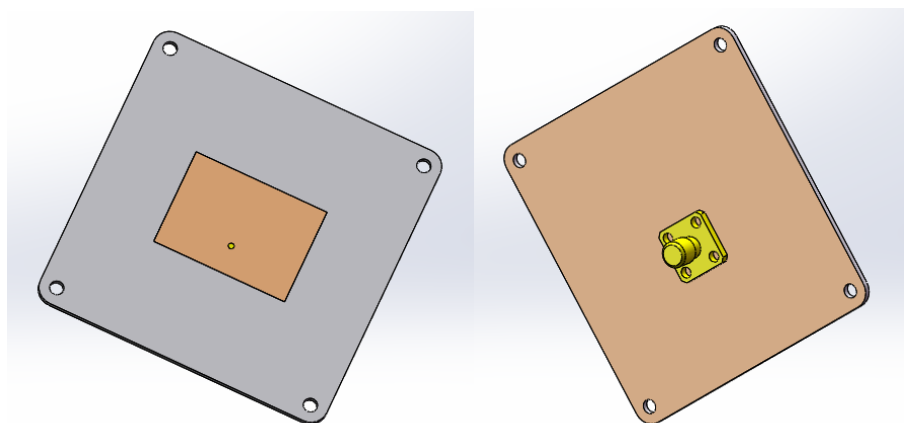

Electrical Specifications

Frequency Range,MHz	3680-3720
Impedance, Ohms	50
Gain[dBi]	7(Typical)
VSWR Max.	2
Beam Width(E*H)	70° X70° (Typical)

Mechanical Specifications

Conn.Type	SMA Female
Size[mm]	70mm×70mm×1.5mm
Operating Range deg.[C]	-55 ~ +75

Outline Drawing (Dimensions are in mm)**Product Picture**

Test Report

VSWR test

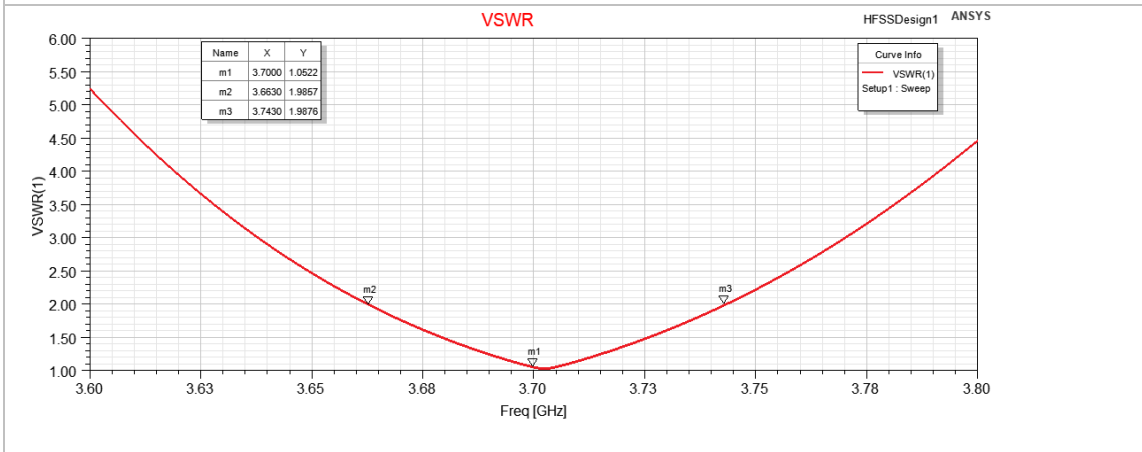

Antenna Pattern

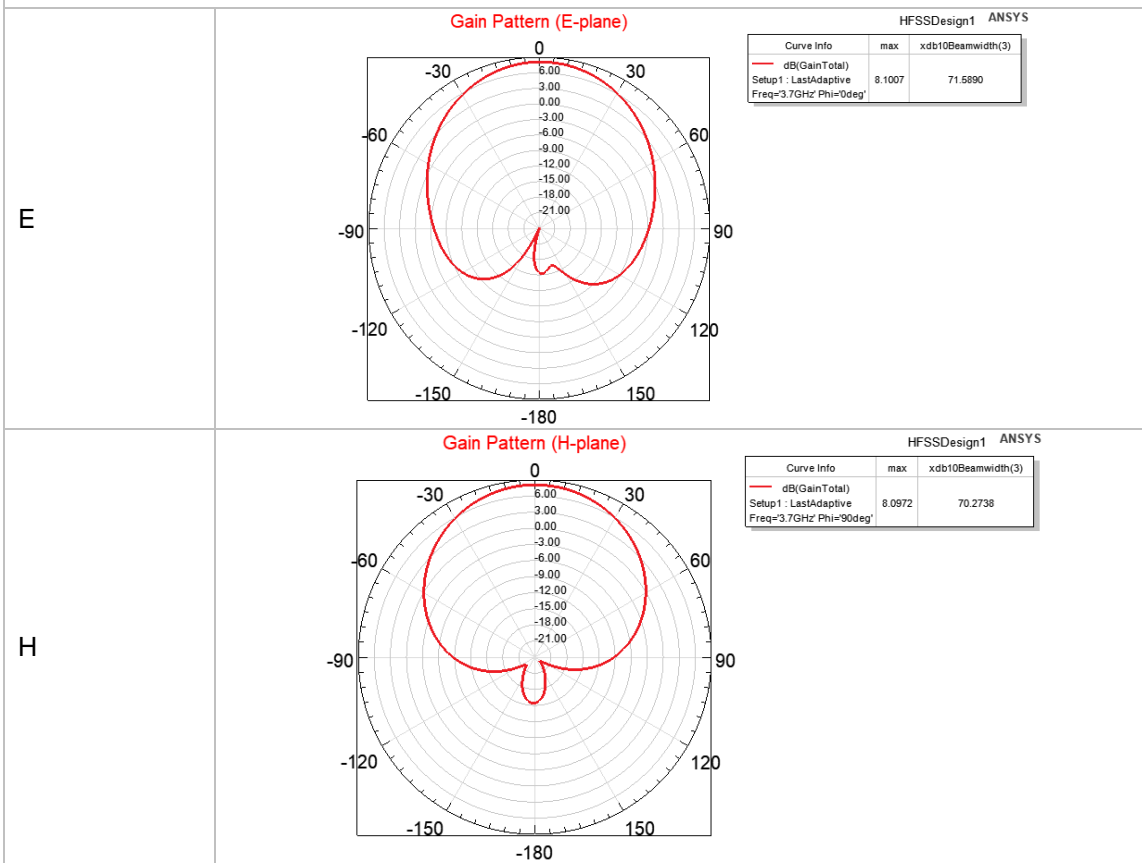

While the information has been carefully compiled to the best of our knowledge, nothing is intended as representation or warranty on our part and no statement herein shall be construed as recommendation to infringe existing patents. In the effort to improve our products, we reserve the right to make changes judged to be necessary.