

## V-Band Waveguide to 1.85mm Connector Adapter

### Description:

These waveguide to coax adapters operate in the frequency range from 50.0 to 75.0 GHz. They are designed and manufactured for instrumentation grade quality, but with commercial price level, allowing efficient transition between the rectangular waveguide to coax connector. These adapters deliver superior RF performance (i.e., low insertion loss and low VSWR). Two mechanical configurations, namely right angle and end launch (in-line), are offered.



### Features:

- Broadband operation
- Low insertion loss and VSWR
- Instrumentation grade

### Applications:

- Test labs
- Instrumentation
- Sub-assemblies

### Device Specifications:

Parameter	Minimum	Typical	Maximum
Frequency Range	50.0 GHz		75.0 GHz
Insertion Loss		0.5 dB	
Return Loss		-16.0 dB	

### Ports Specifications:

Port	Connector	Absolute Maximum Ratings
Waveguide	WR-15 with UG385/U Flange	N/A
Coaxial	1.85mm Female <sup>(1)</sup> or 1.85mm Male <sup>(2)</sup>	N/A

(1) Applies to model SWC-15VF-R1

(2) Applies to model SWC-15VM-R1

## V-Band Waveguide to 1.85mm Connector Adapter

**Mechanical Outline:** (Unless otherwise specified, all dimensions are in inches)

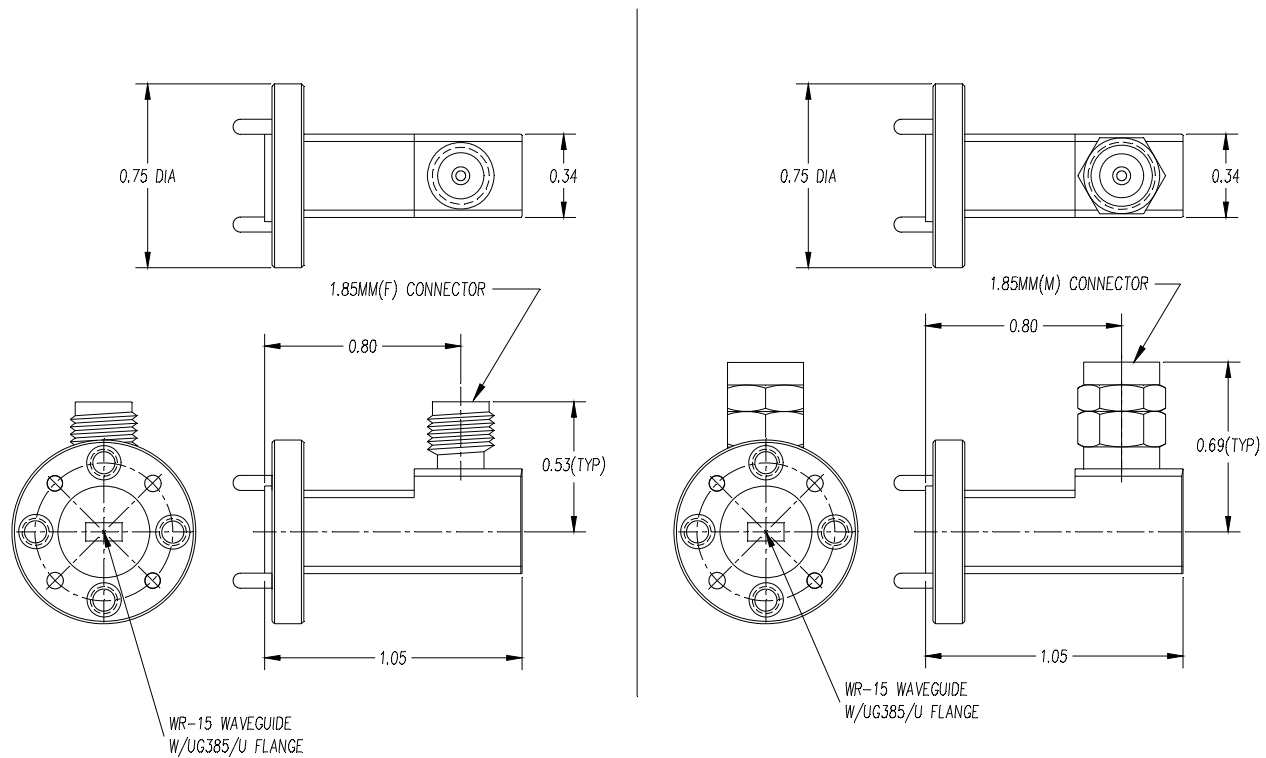

### Note:

- SAGE Millimeter, Inc. reserves the right to change the information presented without notice.
- All data are presented using a limited sample lot, actual data may vary unit to unit.
- All testing was performed under 25°C case temperature.

### Caution:

- Any foreign objects into the waveguide will destroy the adapter.