

## ADAPTOR DATA SHEET

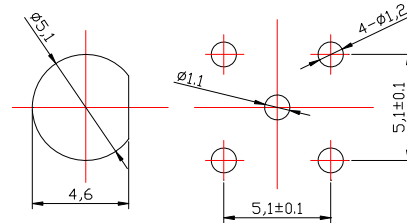

SMB (MALE) FOR PCB

SMB-JYWHD

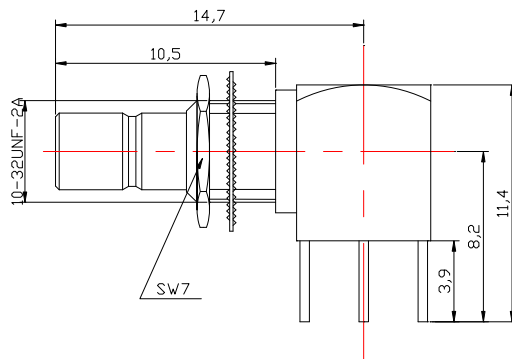

安装开孔尺寸图

## Electrical Specifications

Impedance	50 $\Omega$
Frequency	DC to 4 GHz
Insertion Loss (dB)	$\leq 0.05 \times \sqrt{f_{\text{GHz}}}$
Return loss/VSWR	1.35

## Materials Information

Centre Contact	Brass gold plated
Outer Contact	Brass gold plated
Body	Brass gold plated
Dielectric	PTFE

## Environmental Data

Temperature range	-40°C to +85°C
Vibration	acc.GJB150-16
Temperature Shock	acc.GJB150-05
2002/95/EC(RoHS)	Compliant

While the information has been carefully compiled to the best of our knowledge, nothing is intended as representation or warranty on our part and no statement herein shall be construed as recommendation to infringe existing patents. In the effort to improve our products, we reserve the right to make changes judged to be necessary.

Draft	Checker	Approved	Date	Rev.	ECN	Name	Date
LaiXX	Flex	Grisson	02.11.2011	a	-----	Lai	02.11.2011

Gwave Technology Inc.  
4<sup>th</sup> Floor, New Material Plaza, Yongfeng Hi-Tech Base, Haidian District, Beijing, China(100094) www.gwave-tech.com

Tel.: +86 10 58937305/06  
Fax: +86 10 58937307  
email: gwave@gwave-tech.com

Page

1 / 1