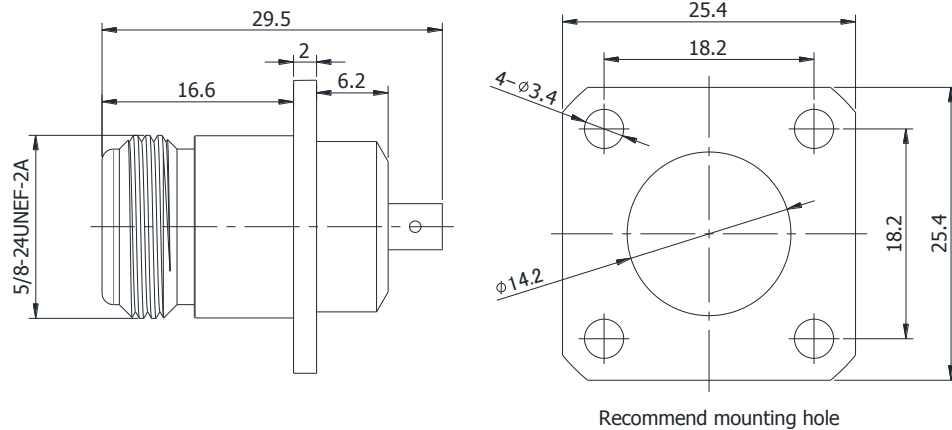

**N STRAIGHT JACK  
WITH 4 HOLE FLANGE**
**N-KFB3-1**

\*Dimensions are in mm

**Configuration**

Connector 1 Type	N Female
Connector 1 Impedance	50 Ohms
Connector 1 Polarity	Standard
Body Style	Straight
Connector Mount Method	4 Hole Flange
Connector 2 Interface Type	141 Series
Cable Attachment Method	Solder

**Electrical Specifications**

Frequency	DC to 6 GHz
Insertion Loss (dB)	$\leq 0.10 \times \sqrt{f_{\text{GHz}}}$
VSWR /Return Loss	1.25 to 6 GHz

**Materials Information**

Center Contact	Phosphor Copper Gold Plated
Outer Contact	Brass Nickel Plated
Body	Brass Nickel Plated
Dielectric	PTFE

**Environmental Data**

Temperature Range	-45°C to +125°C
2002/95/EC(RoHS)	Compliant

While the information has been carefully compiled to the best of our knowledge, nothing is intended as representation or warranty on our part and no statement herein shall be construed as recommendation to infringe existing patents. In the effort to improve our products, we reserve the right to make changes judged to be necessary.