

**GH(FEMALE) FOR PCB 8 POSITION
BOARD CONNECTOR**
GH-ZGJ8TCT.P

Recommended opening size of installation panel:
Installation method: front plate installation

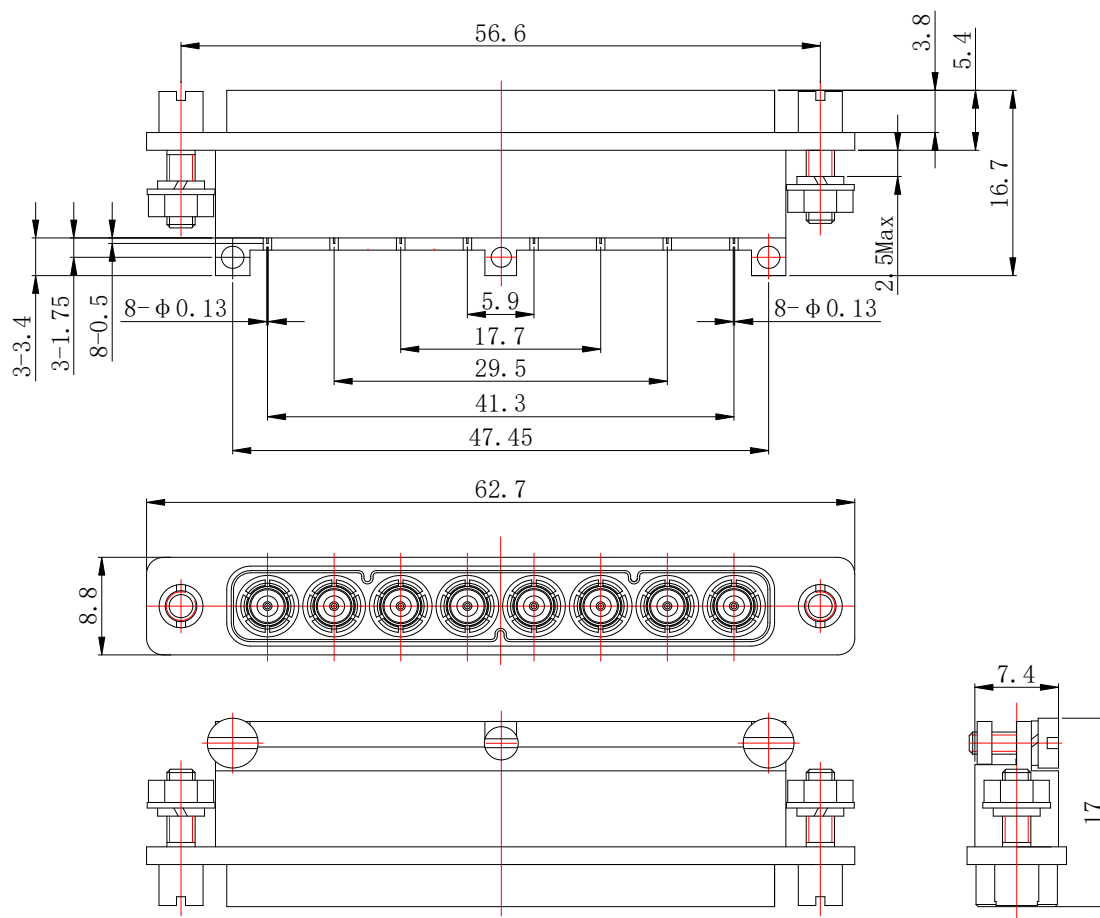

PCB Layout:

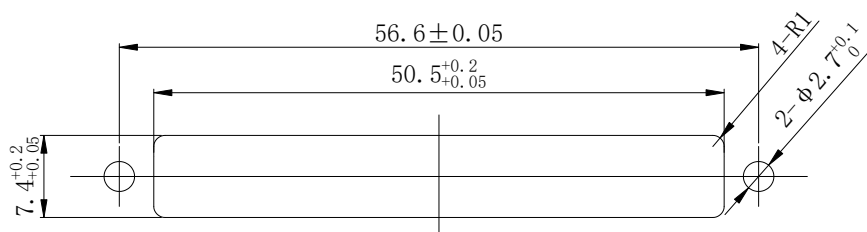
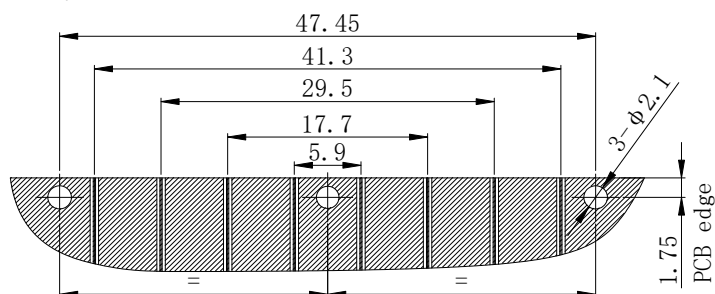

GH(FEMALE) FOR PCB 8 POSITION
BOARD CONNECTOR**GH-ZGJ8TCT.P**

*Label and Shrinking tube design depend on customer's request.

Configuration

Connector Type	GH-ZGJ8TCT.P
Connector Impedance	50 Ω
Body Style	Straight
Connector Mount Method	Φ 0.13mm Pin
Connector Docking End Model	GH-TGK8SCT.P

Electrical Specifications

Frequency	DC to 67GHz
Inertion Loss(dB)	$\leq 0.1 \times \text{Sqrt.}(f_GHz)$
Return Loss/VSWR	1.35 to 67GHz

Materials Information

Centre Contact	Brass Gold Plated
Outer Contact	Stainless Steel
Body	Stainless Steel
Dielectric	PEI

Environmental Data

Temperature Range	-55°C to +125°C
2002/95/EC(RoHS)	Compliant

While the information has been carefully compiled to the best of our knowledge, nothing is intended as representation or warranty on our part and no statement herein shall be construed as recommendation to infringe existing patents. In the effort to improve our products, we reserve the right to make changes judged to be necessary.