

Circulator



50Ω SMA(F) Circulator (4.5 ~ 5.1GHz)

GCN045051-20W

Electrical Specifications

Frequency Range, GHz	4.5 ~ 5.1
Impedance, Ohms	50
Insertion Loss Max.[dB]	0.30@+25°C 0.30@-30~+70°C
Isolation Min.[dB]	22@+25°C 20@-30~+70°C
VSWR Max.	1.20@+25°C 1.25@-30~+70°C
CW Power Max. [W]	20W
Transmission Direction	Clockwise(→)

Mechanical Specifications

Conn.Type	SMA(F)
Operating Range deg.[C]	-30 ~ 70

Outline Drawing

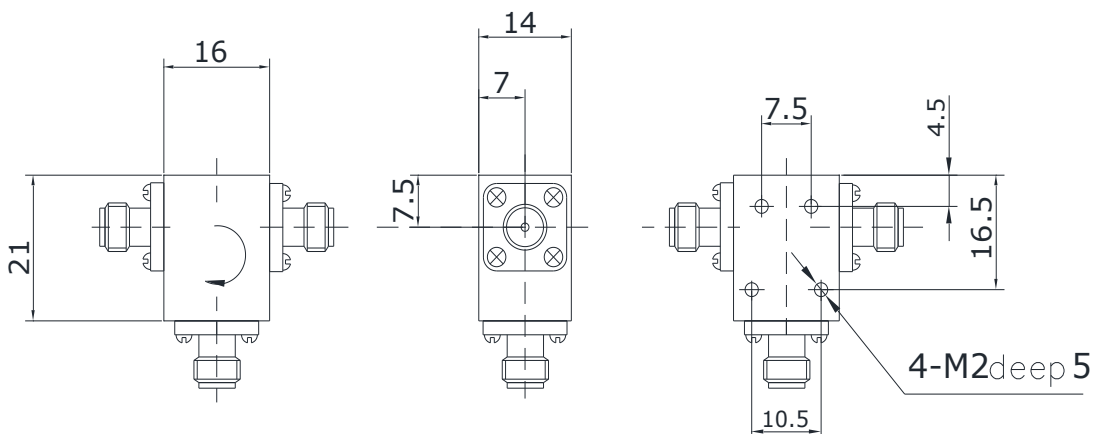

Note: Dimensions (mm), General tolerance (± 0.20)

Notes