

Circulator



50Ω SMA(F) Circulator (2.4 ~ 2.5GHz)

GCN024025-150W

Electrical Specifications

Frequency Range, GHz	2.4 ~ 2.5
Impedance, Ohms	50
Insertion Loss Max.[dB]	0.35@+25°C 0.4@-30~+70°C
Isolation Min.[dB]	21@+25°C 20@-30~+70°C
VSWR Max.	1.20@+25°C 1.25@-30~+70°C
CW Power Max. [W]	150W
Transmission Direction	Clockwise(顺时针 1-2-3)

Mechanical Specifications

Conn.Type	SMA(F)
Operating Range deg.[C]	-30 ~ 70

Outline Drawing

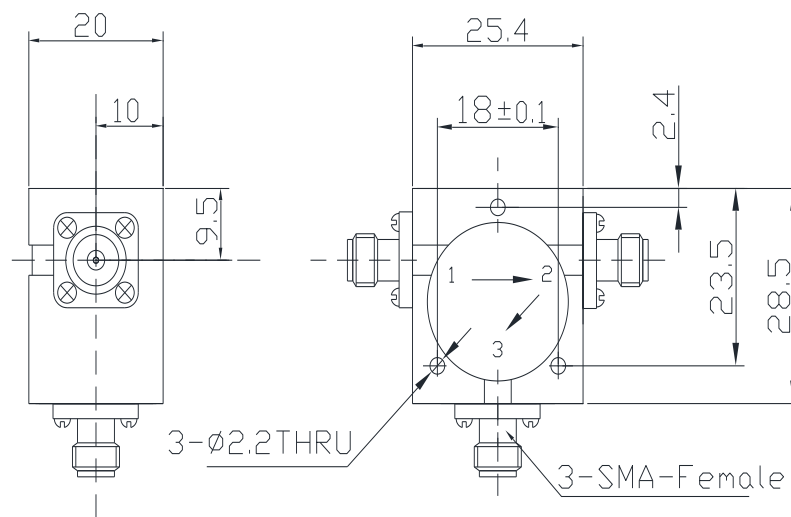

Note: Dimensions (mm), General tolerance (± 0.15)

Notes